

Sarwinplast®

HD-O-MR Gypsum Plaster



12x7 Helpline : 0888 302 4444 | Office : 0467 220 6229 C. care: 0790 220 6229
Email : sarwinplast@gmail.com Web : www.sarwinplast.com



PRESENTS

For the first time in the Indian gypsum plastering industry, we introduce 100% organic, nanopolymer, chemical-free gypsum plastering with greater potency

SARWINPLAST HD-O-MR

Sarwinplast HD-O-MR is an imported Iranian gypsum plaster utilizing nano-polymer technology. It combines 100% organic polymers that resist cracks and moisture, offering superior finishing while eliminating health-damaging chemicals typically found in ordinary gypsum through a triple purification process. This product is approved by Intellectual Property India (Reg. No. 4959973, 29 April 2021, under the Government of India).



LET'S LIVE HEALTHY WITH NATURE WITH SARWINPLAST

Sarwinplast is the only polymerized gypsum currently available in India with comprehensive test certifications.



COMMON ISSUES WITH ORDINARY GYPSUM PLASTER

One of the biggest drawbacks of traditional gypsum plastering is its reaction to moisture in humid climates, which weakens bonding strength over time. This can lead to cracking and paint detachment within eight to ten years.

INTRODUCING SARWINPLAST HD-O-MR POLYMERIZED GYPSUM PLASTER

Sarwinplast HD-O-MR is produced by mixing 100% organic polymers with high-density (HD grade) gypsum, boasting over 95% purity to address the shortcomings of conventional gypsum.

KEY CHARACTERISTICS OF SARWINPLAST HD-O-MR

1. Organic nano-polymers enhance elasticity, preventing rupture.
2. Increased water resistance due to nano-polymers.
3. Provides a superior gloss finish for walls.
4. Reduces paint absorption by 20%, saving paint costs.
5. Enhances paint adhesion for longer-lasting results.
6. Minimizes moisture-related issues.
7. Organic nano-polymers help reduce indoor heat.

8. Extended shelf life due to moisture absorption, slowing crystallization. Unlike traditional gypsum, which has a shelf life of only 3 to 6 months, HD-O-MR offers significantly longer durability.

9. Beware of counterfeit Natural/HD-MR gypsum in the market. When selecting quality gypsum, check the manufacturing date, batch number, shelf life, Government of India IS-Grade Quality Test Certificate, Water Absorption Certificate, and Country of Iran Certificate.



ARE ORGANIC NANO-POLYMERS HARMFUL TO HEALTH?

Organic nano-polymers are commonly used in cosmetics to prevent irritation and for waterproofing applications. Therefore, they are not harmful to health.

PARAMETERS	UNITS	LIMITS	OBSERVATION
Color	-	Super White	Super White
Purity	%	98-99	98.85 %
Whiteness	%	90-92	95 %
Mesh No 200; v	%	0/010-0/025	0/019 %
CaSo4	%	98	98.65 %
So3	%	54.57	57.25 %
Organic Polymer Content	%	5-8	7.10 %
Compressive Strength	N/mm ²	14.60	18.06 %
Flexural Strength	N/mm ²	4.60	5.92 %
Plater/Water Ratio	Kg	1.7-1.8/IL	1.78
Crystal Water	%	3.8	3.95 %
Water Releasing	mm	10-15	12.21 mm
Density	kg/m ³	700-800	815 kg/m ³
Heat-Moisture Rel. Rest	-	-	Pass
Initial Setting Time	M	10-12	11.25 Minutes
Final Setting	inutes	20-24	23.85 Minutes
Water Absorption	M %	-	29.85 %

inutes

SARWINPLAST HD MR-GYPSUM PLASTER: APPLICATION PROCESS STEPS

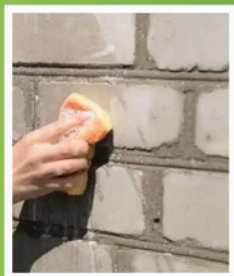

1

Clean loose particles, dirt, grease and traces of adhering material from the wall surface with the help of sand paper, putty blade or by wire brush.



2

Mix Sarwin Gypsum Plaster to water and not water to powder. Water to plaster ratio should be (1 part of water and 1.5 part of gypsum plaster) maintained to provide a good cohesive workable mix.



3

Mix Sarwin Gypsum Plaster to water with the help of hand to form a uniform lump free paste.



4

Install the wooden or steel strip/ dhada or install the leveling strip in the area where the paste needs to be applied. Apply the single coat approx. up to 8 mm to 10 mm of thickness; before the coat sets rake, cross rake the surface.

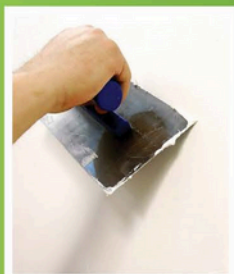

5

Fill in any hollow area, Level off and compact the surface. Then apply the final finish coat.

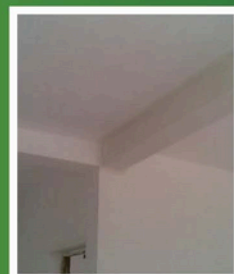

6

After complete drying for usually 72 hrs. (Depending on the thickness and humidity), the plain smooth leveled surface is ready for painting application.



Sarwinplast®

+91 8939845662

vivek@jcegroups.in

Minjur, Chennai.

www.jcegroups.in

Sarwinplast®

NATUR[®] PLAST[®]

MICRO REFINED ULTRA PURIFIED GYPSUM PLASTER

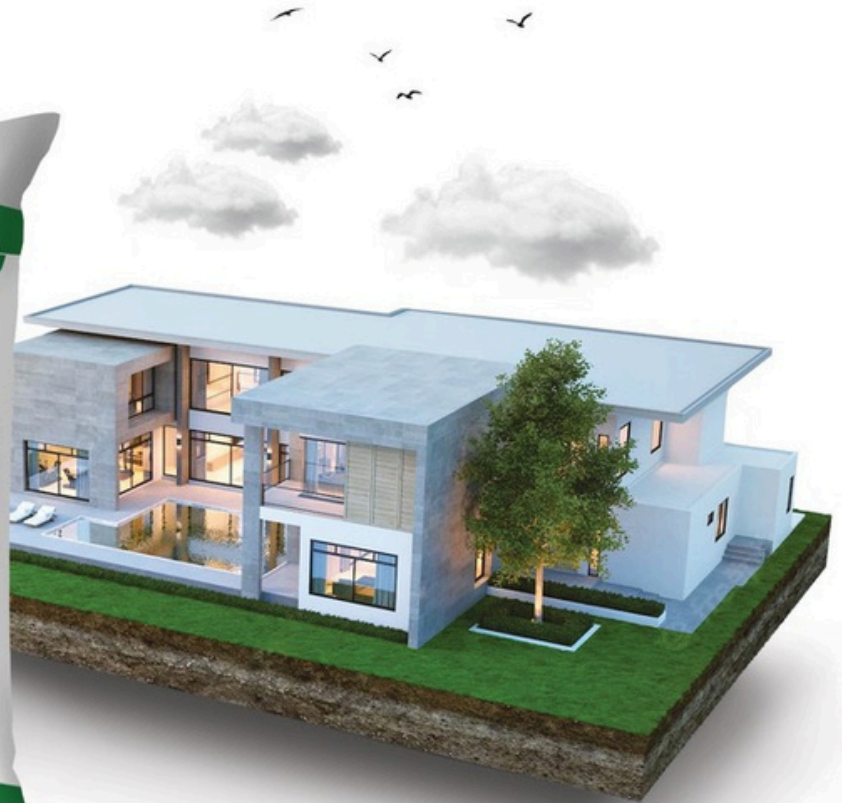

contact us



+91 8939845662



vivek@jcegroups.in

Naturoplast Gypsum Plaster is extra high purity, whiteness and strong performance material to meet the wall & ceiling solutions in all segments of building interiors.

This Gypsum is simpler, faster and easy to apply on the surface areas and after applying it gives a great finishing path for other work. It is light weight gypsum for crack free surfaces and it does not shrink drying and hardening process.

This product does not contain dangerous chloride. In safety and health protection measures this material is not harmful to human life and other environment life.

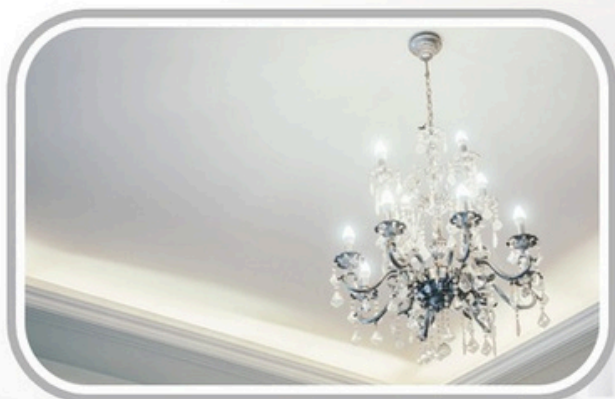

ADVANTAGES OF NATUROPLAST GYPSUM PLASTER

- 2 times faster than conventional sand cement plaster.
- No Shrinkage cracks.
- Saves precious potable quality water as no water curing is required.
- No fine river sand requirement for plastering.
- Keeps rooms cooler, saving energy cost for building occupiers.
- Reduction in structural loads of the building (50% lighter than conventional sand cement plaster).
- LEED points benefit for green building construction.

Naturoplast Gypsum Plaster is the ideal choice for remodelling and repair works. Naturoplast Gypsum Plaster delivers beautiful and quality cornices and decorations. Naturoplast Gypsum Plaster is excellent for the creation of refined textures and smooth surfaces that are free of crack and chip. Naturoplast Gypsum Plaster created healthy and aesthetic indoor ambiance.



Naturoplast Technical Specification & Test Results

Mesh No 200;v%	: 0/015 - 0/030
Compressive strength	: 11.60 N/mm ²
Flexural Strength	: 3.80 N/mm ²
Plaster/Water Ratio	: 1.5 -1.6kg/1L
Crystal Water	: Max. 4.3%
Water Releasing	: 15 - 20 mm
Purity(%)	: 82 - 88
Whiteness(%)	: 85 - 90
CaSo4	: 80 - 85 %
SO3 (%)	: 45.37
Initial Setting Time	: 8 - 10 min
Final Setting Time	: 18 - 20 min
Density	: 600 -700 kg/m3
Weight	: 25 kg ± 5%





Sarwinplast®

NATUR  PLAST®

**MICRO REFINED
ULTRA PURIFIED GYPSUM PLASTER**

Delivers beautiful & quality cornices and
decorations & ideal choice for remodelling and
repair works

contact us



+91 8939845662



vivek@jcegroups.in

Bycrete



Specifications

Technical Parameters complies with IS 1661 – 1972, IS 2250 – 1965, IS 2402 – 1963

Areas of Application

"Bycrete Quic Plast QP is ideal for plastering on inner and outer walls. It can also be used effectively on brick, block, stone walls as well as concrete surfaces. Highly recommended for well-prepared walls requiring thickness of plaster up to 15mm in single layer.

Features & Benefits

- Excellent replacement to conventional plaster
- Assured consistent quality
- Needs lesser curing than conventional plaster
- Reduced water absorption hence enhanced durability
- Provides uniform and smooth finish to walls
- Lesser rebound loss than conventional plaster
- Quality plastering since it contains no impurities
- Speedy work due to convenience in application
- Minimal wastage

Directions of Usage

Surface Preparation

- Prepare the surface before the application of BYCRETE QUIC PLAST QP by removing oil, bond inhibiting agents, dirt, dust and laitance
- Clean the surface following suitable methods like by using wire brush, water jetting, mopping, etc.
- Pre-wet the surface before the application of BYCRETE QUIC PLAST QP.

Mixing

- BYCRETE QUIC PLAST QP requires 16 – 19 % potable water by weight of material.
- Add BYCRETE QUIC PLAST QP to the measured quantity of water and mix for 2 – 3 minutes to ensure a consistency free of lumps
- Mix only the required quantity of material which can be consumed within the 1 hour pot life and do not add more water than the prescribed water ratio to the already mixed BYCRETE QUIC PLAST QP

Application

- BYCRETE QUIC PLAST QP can be applied using mortar trowels or spatula like in conventional system requiring no additional mason training
- BYCRETE QUIC PLAST QP can be applied for thickness up to 15 mm in single layer. For thickness above 15 mm, multiple layer application is recommended.

Technical Data As Per Relevant IS Standards

Bulk Density	1500 – 1600 Kg/m ³
Water Powder Ratio	16 – 19 % By Weight
Pot Life	1 Hour @ 27°C
Compressive Strength @ 28 Days	Minimum 10 MPa
Coverage / 40kg bag (Depending on the substrate)	18 – 22 Sq.Ft @ 12 mm
Thickness of layer	08 – 15 mm per coat
Curing	02 – 03 days @ 2 – 3 times a day
Wastage	Negligible

Note

- Allow a minimum of 48 hours for the subsequent usage over BYCRETE QUIC PLAST QP applied areas. Do not apply if temperature is likely to drop below 5°C or exceed 50°C. For harsh climate, curing has to be done for 4-5 days with consultation of technical services cell
- The technical data provided in this technical data sheet is as per lab testing conditions and may vary as per the actual method of application at sites.
- Consult BYCRETE Technical Services Cell for any further technical assistance.

Safety Directions

- BYCRETE QUIC PLAST QP is non-toxic. Use of gloves and goggles recommended. Any splashes to the skin or eyes should be washed off with clean water immediately.
- In case of prolonged irritation, medical advice should be sought, BYCRETE QUIC PLAST QP is non-flammable.

Shelf Life

- BYCRETE QUIC PLAST QP has a shelf life of 12 months from the date of manufacture. Store in a cool dry place.

Packaging

40 KG

**+91 8939845662****vivek@jcegroups.in****www.expertbuildcare.in****Coimbatore, Tamil Nadu**



GYPSUM CEILING BOARD

HD - MR MULTIPURPOSE

PLAIN

MOISTURE FREE

HEAT GUARD

CEILING ARTISTRY WITH
SARWINPLAST GYPSUM BOARDS



+91 8939845662

vivek@jcegroups.in

GYPSUM BOARD

Gypsum board, commonly known as drywall, is a technical product term used by manufacturers for a specific board with a gypsum core and a paper facing. Normally, gypsum board is a premier building material for wall, ceiling, and partition systems in residential, industrial, and commercial structures. This product is designed to provide a monolithic surface to schemes, and a seamless appearance is obtained as the joints and fastener heads are covered with a joint treatment system. Gypsum board is a panel made of calcium sulfate dihydrate (gypsum) with or without additives and normally pressed between a facer and a backer (typically thick sheet of paper). Gypsum board is used to make interior walls and ceilings, and it is often called drywall or plasterboard. It differs from other panel-type building products, such as plywood, hardboard, and fiber board, because of its non-combustible core and paper facer. When joints and fastener heads are covered with a joint compound system, gypsum wallboard creates a continuous surface suitable for most types of interior decoration.

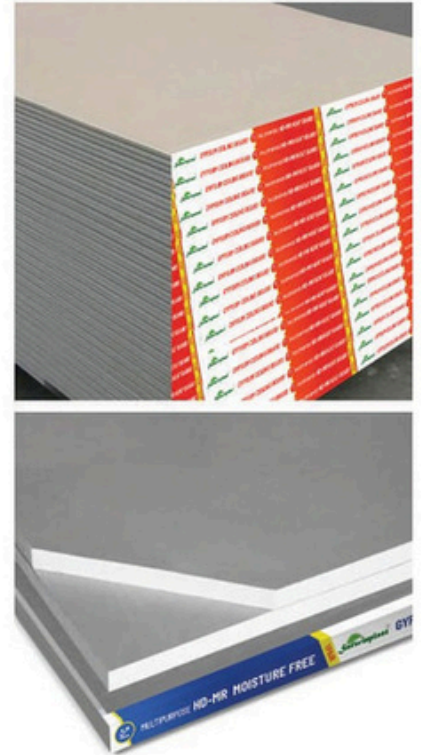

ADVANTAGES



EASE OF INSTALLATION



DURABLE



VERSATILE



FIRE RESISTANT



SOUND
INSULATION



ECONOMICAL



ECO FRIENDLY



LIGHTWEIGHT &
FLEXIBLE



CRACK-FREE

SARWINPLAST HAS 3 CATEGORIES OF BOARD



SARWINPLAST HD-MR :
PLAIN



SARWINPLAST HD-MR :
HEAT GUARD



SARWINPLAST HD-MR :
MOISTURE-FREE



PARAMETER	PLAIN BOARD	HEAT GUARD	MOISTURE-FREE
Thickness (mm)	9.5/12.5/15	9.5/12.5/15	9.5/12.5/15
Size (mm)	1220x1830 1220x2440 1220x3000	1220x1830 1220x2440 1220x3000	1220x1830 1220x2440 1220x3000
Board Color	Front: Ivory Back: Gray	Front: Ivory Back: Silver	Front: Ivory Back: Green
Edge Type	Square Edge Tapered Edge	Square Edge Tapered Edge	Square Edge Tapered Edge
Thermal Conductivity	0.19 w/mk	0.24 w/mk	0.19 w/mk

SARWINPLAST HD-MR : PLAIN

- Provides various design innovations in building infrastructure.
- Cost-effective and quality solution.
- Suitable for points, textures, and wall covering materials



SARWINPLAST HD-MR : HEAT GUARD

- HEAT GUARD Board naturally maintain temperature of your work area.
- It Board is specially laminated with Metallic foil on it's back side.
- It Board provides upto 90% heat reflection.



SARWINPLAST HD-MR : MOISTURE-FREE

- It absorbs less moisture when exposed to moisture as compared to other boards.
- Used directly without other boards beneath.
- It is used in kitchens, washrooms, toilets, and other moist areas.





Sarwinplast®

GYPSUM CEILING BOARD **HD - MR MULTIPURPOSE**

PLAIN

MOISTURE FREE

HEAT GUARD

12 x 7 Helpline : 811004484 | Office : 0422 4124520 | Customer Care : 8110044744



+91 8939845662



vivek@jcegroups.in



CEILING BOND

WATER-PROOF WITH HACK & RUST-FREE POLYMER

**Plasterings on the smooth
concrete ceilings**

Falling off...

**May be getting you in
trouble tomorrow...?**



In the new building construction method, the ceiling was very smooth when concrete was made with metal sheet, and the oil contents used to prevent the metal sheet from rusting and the plastic used to prevent the concrete from leaking remain in the ceiling, so there is a high possibility that the bonding between the ceiling and the plastering will be lost and the plastering will fall off in the future when using gypsum plaster or cement plaster.

Sarwinplast Water-Proof Ceiling Bond with Nano Polymer Technology is a new generation material introduced by Sarwinplast – for plastering without chipping or grouting and for better bonding with concrete.

It contains nano water-proofing polymers that prevent moisture penetration into the ceiling and protect the wires from rusting.



Net. Weight : 20kg
Coverage : 125-150 sft/1kg

Now
we can plaster
the ceiling very easily
without any tension..!!

**Sarwinplast**[®]
EXPERT BUILD CARE



 +91 8939845662

 vivek@jcegroups.in

Sarwinplast[®]
PLASTROGUARD
WATER PROOF GYPSUM & CEMENT PRIMER PAINT

GET A **BRAND NEW HOUSE FOREVER**
WITH **SARWINPLAST PLASTROGUARD**
WATER PROOF GYPSUM & CEMENT PRIMER PAINT

3 IN ONE PROTECTION



Sarwinplast Plastroguard Water Proof Gypsum & Cement Primer Paint, Is A Water Proof Coating Which Protects The Base Materials Of A Wall From Getting Moisture Content In And Out Before Painting. It Keeps Your House's Plastering And Painting Fresh Even In Humid Weather.

Net. Weight : **10kg**

Coverage

Single Coat: 800 Sqft/10 kg

(Coverage depends upon the nature of the surface to be applied. But on average, smooth surface will give approx 800 sqft/10kg per coats, DFT about 50-60 microns)



Sarwinplast Plastroguard Water Proof Gypsum & Cement Primer Paint, provides for more bonding of paint with the upper surface of the wall and it also protects the charm of paint on walls exposed to moisture without losing its beauty. By using sarwinplast Plastroguard Water Proof Gypsum & Cement Primer Paint, it is possible to solve the problems that may arise in the future, due to the presence of moisture in the atmosphere in houses with ordinary gypsum plastering. sarwinplast Plastroguard Water Proof Gypsum & Cement Primer Paint helps to maintain the durability, strength and beauty of buildings in any weather.



**“ENSURE
PROTECTION
WITH
SARWINPLAST,
IN ANY WEATHER”**



 +91 8939845662

 vivek@jcegroups.in

Sarwinplast®



PRODUCT
BROCHURE

Description

POLYTEK XTRA SHIELD is a single pack liquid based on elastomeric, hydrophobic polyurethane resins of excellent mechanical, chemical, thermal, UV and weather resistance. Forms a continuous, elastic, waterproof and vapor-permeable membrane, without seams or joints, with ensuring long lasting protection.

Instructions for application

- ✓ Clean the surface thoroughly by removing dust, dirt, oil, and curing compound.
- ✓ Repair cracks and potholes using Nano Bond MD and let it cure.
- ✓ Apply Nano Bond HD primer at a rate of 25 sqft/kg. Once the primer is dry, use CRACK BOND to fill cracks larger than 1 mm.
- ✓ Place a 45 gsm fiber mesh and apply a second coat of Nano Bond HD primer.
- ✓ Once the second coat dries, apply a third coat of Nano Bond HD.
- ✓ After primer is dries, apply POLYTEK XTRASHIELD coating.
- ✓ After drying, apply a third coat of the coating.
- ✓ Let the final coated surface cure for a minimum of 3 days.

MRP ₹3000
(incl. of all taxes)

Coverage

16-20 Sq.ft / Kg for Coats

Benefits

- Excellent waterproofing
- Good weather and UV resistance.
- Reduces temperature up to 20 °C.
- Strong abrasive resistant. Ready to use, Easy to apply. Not susceptible to bacteria attack. Resistance to ponded water. Single pack with high Tensile strength. Durable and remains elastic at extreme temperatures. 15-years of product warranty*.

POLYTEK XS



Description

POLYTEK HS is a single pack elastomeric polyurethane based coating. Engineered to provide exceptionally durable and effective waterproofing for both concrete and steel surfaces, this solution ensures extended protection. Designed for outdoor use, it boosts UV resistance and is uniquely crafted for external applications.

Instructions for application

- ✓ Clean the surface thoroughly by removing dust, dirt, oil, and curing compound.
- ✓ Repair cracks and potholes using Nano Bond MD concrete repair system and let it cure.
- ✓ Apply Nano Bond HD primer at a rate of 25 sqft/kgs. Once the primer is dry, use CRACK BOND to fill cracks larger than 1 mm.
- ✓ Place a 45 gsm fiber mesh and apply a second coat of Nano Bond HD primer.
- ✓ Once the second coat dries, apply a third coat of Nano Bond HD.
- ✓ After primer drying, apply POLYTEK HS coating.
- ✓ After drying first coat of polytek Hs, Apply the second coat with the same coverage rate as the first coat.
- ✓ After drying, apply a third coat of the coating.
- ✓ Let the final coated surface cure for a minimum of 3 days.

Coverage

16-20Sq.ft/Kgfor3 coats.

Benefits

- Excellent water impermeability.
- Temperature reduced by upto 8-15°C.
- Creates Crack Bridge and remains its elasticity.
- High adhesion strength, UV resistant and color retention.
- Ready to use, Easy to apply.
- 10-years of product warranty*.

POLYTEK HS



100% WATER
PROOFING



HIGH CRACK
BRIDGING
PROPERTY



ELONGATION UP
TO 20 MM



LONG
LASTING



UP TO 15° C
TEMPERATURE
REDUCTION



UV
RESISTANT



ECO
FRIENDLY



10 YEARS
WARRANTY

Description

POLYTEK stands out as a liquid-applied, single-component elastomeric polyurethane coating. Meticulously engineered to provide enduring, hassle-free, and top-tier waterproofing safeguard for concrete structures. Featuring a medium-density polyurethane composition, it delivers exceptional protection and is expertly tailored for outdoor use.

Instructions for application

- ✓ Clean the surface thoroughly by removing dust, dirt, oil, and curing compound.
- ✓ Repair cracks and potholes using Nano Bond MD concrete repair system and let it cure.
- ✓ Apply Nano Bond HD primer at a rate of 25 sqft/kgs.
- ✓ Once the primer is dry, use CRACK BOND to fill cracks larger than 1 mm.
- ✓ Place a 45 gsm fiber mesh and apply a second coat of Nano Bond HD primer.
- ✓ Once the second coat dries, apply a third coat of Nano Bond HD.
- ✓ After primer drying, apply POLYTEK coating.
- ✓ After drying first coat of polytek , Apply the second coat with the same coverage rate as the first coat.
- ✓ After drying, apply a third coat of the coating
Let the final coated surface cure for a minimum of 3 days.

Coverage

13-15 Sq.Ft / Kg for 3 Coats

Benefits

- Excellent water impermeability.
- Temperature reduced by up to 8°C.
- Creates Crack Bridge upto 15MM.
- Excellent adhesion performance.
- High Elasticity and Abrasion Resistance.
- High adhesion strength, UV resistant and color retention.
- Ready to use, Easy to apply.
- 5-years of product warranty*.

POLYTEK



100%WATER
PROOFING



HIGH CRACK
BRIDGING
PROPERTY



ELONGATION UP
TO 15 MM



LONG
LASTING



UP TO 15° C
TEMPERATURE
REDUCTION



UV
RESISTANT



ECO
FRIENDLY



5 YEARS
WARRANTY

Description

Nano Bond HD is a carboxylate styrene butadiene copolymer latex admixture that is designed as an integral adhesive for cement bond coats, mortars and concrete to improve bond an integral adhesive for cement bond coats, mortars and concrete to improve bond strength and chemical resistance. Nano Bond HD is an acrylic based admixture that used plasters and screed to improve adherence and impermeability. It necessitates on-site blending with water and cement in proper proportions to get easily brushable coating. The application methods encompass a stiff brush, roller brush, or sprayer gun for achieving the desired thickness. In interior and exterior plasters of terrace, water tanks, pools and reinforced concrete silo.

Instructions for application

- ✓ Ensure a clean surface, free from dust, loose materials, and contaminants.
- ✓ Pre-wet the surface before applying Nano Bond Modified SBR latex HD, waiting for water sheen to vanish before Nano Bond Modified SBR latex HD.
- ✓ For waterproofing coat or bonding coat , ratio of Nano bond :water : cement = 1:4:7.
- ✓ For mortar application, ratio of Nano bond: water: cement : sand = 1:4:10:50.
- ✓ For crack filling, ratio of Nano bond: water: cement: sand = 1:4:10:50.
- ✓ For injection grout, ratio of Nano bond: water = 1:5 .

Coverage

30-40Sq.Ft/Kgfor3 Coats

Benefits

- Adhesion to most substrates (concrete, stone, brick, ferrous metals, ceramic tiles).
- Excellent adhesion performance in interior and exterior applications.
- High abrasion resistance and Improves the durability without any cracks.
- Excellent water impermeability

NANO BOND HD



SHRINKAGE
REDUCTION



CRACK
PREVENTION



BONDING
AGENT



DUST
CLEARANCE



ABRASION
RESISTANCE



ECO
FRIENDLY

Description

Nano Bond MD is a carboxylate styrene butadiene copolymer latex admixture that is designed as an integral adhesive for cement bond coats, mortars and concrete to improve bond strength and chemical resistance. Nano Bond MD is an acrylic based admixture that used plasters and screed to improve adherence and impermeability. It necessitates on-site blending with water and cement in proper proportions to get easily brushable coating. The application methods encompass a stiff brush, roller brush, or sprayer gun for achieving the desired thickness. In interior and exterior plasters of terrace, water tanks, pools and reinforced concrete silo.

Instructions for application

- ✓ Ensure a clean surface, free from dust, loose materials, and contaminants.
- ✓ Pre-wet the surface before applying Nano Bond Modified SBR latex HD, waiting for water sheen to vanish before Nano Bond Modified SBR latex HD.
- ✓ For waterproofing coat or bonding coat, ratio of Nano bond :water : cement = 1:4:7.
- ✓ For mortar application, ratio of Nano bond: water: cement : sand = 1:4:10:50.
- ✓ For injection grout, ratio of Nano bond: water = 1:5.

Coverage :

25 - 35 Sq.Ft / Kg for 3 Coats

Benefits

- Strong bond with concrete, plaster, stone works and etc.,
- Enhanced tensile strength and flexural properties for thin application.
- Compatible with various hydraulic cements
- Improves water and chemical resistance
- Improves water and chemical resistance Inhibits cracking
- Improves surface hardening, limits wear and dust production.

NANO BOND MD



SHRINKAGE
REDUCTION



CRACK
PREVENTION



BONDING
AGENT



DUST
CLEARANCE



ABRASION
RESISTANCE



ECO
FRIENDLY

Description

BOUNCY 2K COAT (SHARP) is a cement-acrylic based, two-component, full-elastic insulation material used on concrete, curtain and cement based plasters and applied from the inside and outside against leaking and surface water. It consists of a liquid and powder when mixed together forms an easily brushable coating.

Instructions for application

- ✓ Application substrate must be dry, sound, mainly smooth, and clean.
- ✓ The application surface must be clear of materials which prevent bonding, such as oil, dust, paint, silicone, curing agents, detergents and paraffin wax.
- ✓ Use nano bond primer coat first layer and over the primer coat weak parts of the concrete must be repaired with crack bond.
- ✓ The surface must be saturated with water and must be kept moist during the application.
- ✓ Prepared BOUNCY 2K (SHARP) mixture is applied by brush or trowel as two or three layers.
- ✓ Brush application direction in each layer must be perpendicular to each other.
- ✓ Second layer must be applied before the first layer is not completely dry. In case the first layer is dry, the surface must be moisturized again before the application of the second layer.
- ✓ It is recommended to use a mesh between the layers. Using mesh increases the reinforcing properties of the product.

Coverage :

35 Sq.Ft / Kg for Coats

Benefits

- It forms a water impermeable layer under screeds and ceramics with high adhesion performance and elastic properties.
- Strong bonding with cement and tiles.
- Easy application on surfaces.
- Excellent grip on applied area.
- Damp-proof to prevent water penetration.
- Long-lasting and durable waterproof coating.

BOUNCY 2K COAT SHARP



100% WATER
PROOFING



HIGH CRACK
BRIDGING
PROPERTY



BONDING
AGENT



LONG
LASTING



PREVENTING
WATER
PENETRATION



STRONG
BONDING



ECO
FRIENDLY

Description

BOUNCY 2K COAT (SHINE) is a cement-acrylic based, two-component, full-elastic insulation material used on concrete, curtain and cement based plasters and applied from the inside and outside against leaking and surface water. It consists of a liquid and powder when mixed together forms an easily brushable coating.

Instructions for application

- ✓ Application substrate must be dry, sound, mainly smooth, and clean.
- ✓ The application surface must be clear of materials which prevent bonding, such as oil, dust, paint, silicone, curing agents, detergents and paraffin wax.
- ✓ Use nano bond primer coat first layer and over the primer coat weak parts of the concrete must be repaired with crack bond.
- ✓ The surface must be saturated with water and must be kept moist during the application. Prepared BOUNCY 2K (SHINE) mixture is applied by brush or trowel as two or three layers. Brush application direction in each layer must be perpendicular to each other.
- ✓ Second layer must be applied before the first layer is not completely dry.
- ✓ In case the first layer is dry, the surface must be moisturized again before the application of the second layer.
- ✓ It is recommended to use a mesh between the layers.
- ✓ Using mesh increases the reinforcing properties of the product.

Coverage :

35Sq.Ft/Kgfor Coats

Benefits

- 100% waterproofing for wet areas such as bathroom, kitchen, balcony.
- Strong cement and tile bonding.
- Elastic, does not shrink and crack.
- Provides seamless water isolation without joints.
- Can be used safely in drinking water tanks..

BOUNCY 2K COAT SHINE



100%WATER
PROOFING



HIGH CRACK
BRIDGING
PROPERTY



BONDING
AGENT



LONG
LASTING



PREVENTING
WATER
PENETRATION



STRONG
BONDING



ECO
FRIENDLY

Description

CHILL COAT, a Japanese –engineered pure acrylic Elastomeric Liquid Heat-proofing Membrane that creates a protective layer against heat and UV radiation. Its elastomeric, UV-resistant shield safeguards structures from extreme heat and expansion-related damage. Versatile for concrete, sheet metals, and asbestos use.

Instructions for application

- ✓ Clean surface from dust, dirt, oil, and particles.
- ✓ Use wire brush or scrubber for thorough cleaning.
- ✓ Pay attention to edges and corners.
- ✓ Optional primer for strong bonding in mirror finish, use Sarwinplast Versatile Primer or Nano Bond Modified SBR Latex.
- ✓ Apply two or three coats of CHILL COAT, using hand brush for first coat.
- ✓ Allow each coat to dry before next application.
- ✓ Keep surface dry for a week minimum.

Coverage :

50 Sq.Ft / Kg for 1 Coat

Benefits

High sun poweruvrays reflection.

- Low thermal conductivity.
- Effective heat reduction coating.
- Enhanced temperature insulation for energy savings.
- Reflective exterior coating for roofs, terraces, and walls.
- Minimizes exterior-to-interior heat conductivity.
- High solar reflectance index (SRI) indicates high degree of cooling effect.
- Lowers surface temperature by 15 - 20°C.

CHILL COAT



MRP - ₹0650
(incl. of all taxes)



HIGH
SRI VALUE



HIGH CRACK
BRIDGING
PROPERTY



ELONGATION UP
TO 15 MM



LONG
LASTING



UP TO 15° C
TEMPERATURE
REDUCTION



UV
RESISTANT



ECO
FRIENDLY



ECONOMY

Description

CHILL COAT PLUS The pinnacle of Japanese engineering, this acrylic Elastomeric Liquid Heat-proofing Membrane forms an impermeable barrier against heat and UV rays. Its UV-resistant shield fortifies structures against extreme temperatures and expansion. Adapt it for concrete, sheet metals, and asbestos, experiencing unmatched protection. Elevate your building's defense against heat with this meticulously crafted solution, fending off UV rays and preventing damage. Its versatility spans materials, ensuring longevity with sophistication.

Instructions for application

- ✓ Thoroughly clean surface using wire brush or scrubber. Focus on edges and corners.
- ✓ Optional primer for strong bonding in mirror finish, use Sarwinplast Versatile Primer or Nano Bond Modified SBR Latex.
- ✓ Apply two to three coats of CHILL COAT PLUS, using hand brush for first coat.
- ✓ Elevate protection with CHILL COAT PLUS for enduring quality. Precisely clean surfaces for a seamless application experience.
- ✓ Unleash CHILL COAT PLUS's longevity, ensuring lasting safeguarding.
- ✓ Enjoy a premium coating, professionally applied for unmatched performance.

Coverage :

60 Sq.Ft / Kg for 1 Coat

Benefits

- High sunpowerreflection for energy efficiency. Low thermal conductivity for optimal insulation. High solar reflectance index (SRI) indicates high degree of cooling effect. Reduced energy consumption and savings. Reflective exterior coating for roofs, terraces, walls. Minimizes exterior-to-interior heat transfer. Lowers surface temperature by 15 - 20°C. Durable, weather-resistant, and UV- protected. Seamless, uniform finish for aesthetics. Suitable for residential and commercial use.
-
-

CHILL COAT PLUS



Description

ACRYLIC RED a Superior elastomeric waterproofing with remarkable water repellency. This advanced solution forms a durable shield against moisture, enhancing surface longevity.

Instructions for application

- ✓ All surface to be coated must be clean, dry, free from dust, dirt, oil and other contaminants.
- ✓ Repair cracks and potholes using Nano Bond MD concrete repair system and let it cure.
- ✓ Apply Nano Bond MD primer at a rate of 25 sqft/kgs.
- ✓ Place a 25 gsm Recron Mat and apply a secondcoat of Nano Bond MD primer.
- ✓ Once the second coat dries, apply a third coat of Nano Bond MD.
- ✓ After primer dries, apply acrylic red coating.
- ✓ After drying first coat of acrylic red, apply the second coat with the same coverage rate as the first coat.

Coverage :

50 Sq.Ft / Kg for 1 Coat

Benefits

- Advanced elastomeric waterproofing formula.
- Creates a robust water-repellent barrier.
- Protects surfaces from moisture and water damage.
- Offers superior resistance to water penetration.
- Enhances the longevity of treated surfaces.
- Suitable for a variety of substrates.
- Easy to apply with various methods.
- Provides effective protection against the elements.
- Durable and long-lasting performance.
- Ideal for both residential and commercial applications.

ACRYLIC RED



Description

Acrylic white is an elastomeric acrylic resin based, single component, UV resistant, ready to use waterproofing material. . May be applied by brush, roller, squeegee or spray equipment depending on the site.

Instructions for application

- ✓ All surface to be coated must be clean, dry, free from dust, dirt, oil and other contaminants.
- ✓ Repair cracks and potholes using Nano Bond MD concrete repair system and let it cure.
- ✓ Apply Nano Bond MD primer at a rate of 25 sqft/kgs.
- ✓ Place a 25 gsm Recron Mat and apply a secondcoat of Nano Bond MD primer.
- ✓ Once the second coat dries, apply a third coat of Nano Bond MD.
- ✓ After primer drying, apply acrylic white coating.
- ✓ After drying first coat of acrylic white, apply the second coat with the same coverage rate as the first coat.

Coverage :

50 Sq.Ft / Kg for 1 Coat

Benefits

- Advancedelastomeric waterproofing formula.
- Single component with water-repellent barrier.
- Ready to use, easy to apply.
- High adhesion strength and Colorable.
- Creates Crack Bridge and remains its elasticity.
- UV resistant, Water-based, nontoxic, and nonflammable.
- Ideal for both residential and commercial applications.

ACRYLIC WHITE



Water
Repellent



High
Bonding



ELONGATION UP
TO 15 MM



LONG
LASTING



UP TO 15° C
TEMPERATURE
REDUCTION



UV
RESISTANT



ECO
FRIENDLY



ECONOMY

Description

Experience waterproofing redefined with ACRYLIC GREY. A cutting-edge elastomeric solution that boasts exceptional water repellency, providing robust protection against moisture and environmental challenges. A steadfast guardian against nature's forces, ACRYLIC GREY ensures surfaces maintain their resilience and pristine appearance. Its adaptability across various applications ensures unparalleled protection and performance, pushing boundaries with its state-of-the-art technology.

Instructions for application

- ✓ All surface to be coated must be clean, dry, free from dust, dirt, oil and other contaminants.
- ✓ Repair cracks and potholes using Nano Bond MD concrete repair system and let it cure.
- ✓ Apply Nano Bond MD primer at a rate of 25 sqft/kgs.
- ✓ Place a 25 gsm Recron Mat and apply a secondcoat of Nano Bond MD primer.
- ✓ Once the second coat dries, apply a third coat of Nano Bond MD.
- ✓ After primer drying, apply acrylic grey coating.
- ✓ After drying first coat of acrylic grey, apply the second coat with the same coverage rate as the first coat.

Coverage :

50 Sq.Ft / Kg for 1 Coat

Benefits

- Advanced elastomeric waterproofing formula.
- Creates a robust water-repellent barrier.
- Protects surfaces from moisture and water damage.
- Offers superior resistance to water penetration.
- Enhances the longevity of treated surfaces.
- Suitable for a variety of substrates.
- Easy to apply with various methods.
- Provides effective protection against the elements.
- Durable and long-lasting performance.
- Ideal for both residential and commercial applications.

ACRYLIC GREY



Description

Experience the versatility of VERSATILE WALL PRIMER: A game-changing solution powered by special acrylic polymer. This exceptional primer redefines surface preparation with its superior water repellency capabilities. Crafted to perfection, it forms a resilient barrier that fends off moisture, ensuring surfaces remain dry and well-protected. VERSATILE WALL PRIMER's innovative formula enhances adhesion, making it the ideal foundation for a range of finishes. Elevate your surfaces with a primer that goes beyond expectations, securing lasting protection and optimized performance.

Instructions for application

- ✓ Ensure clean, dry surface free from debris, repair cracks and holes.
- ✓ Repair cracks and potholes using Nano Bond MD concrete repair system and let it cure
- ✓ Apply first coat of versatile wall primer using by brush method.
- ✓ Regular checks and reapply as needed.
- ✓ Allow complete cure as per manufacturer's specifications, avoid moisture.

Coverage :

80 Sq.Ft / Kg for 1 Coat

Benefits

- Easy to apply.
- Prevents peeling.
- Superior water repellency for moisture resistance.
- Promotes strong adhesion for various finishes.
- Increases the longevity of coatings and paints.
- Ideal for both interior and exterior applications.
- Versatile primer suitable for a wide range of surfaces.
- Provides a reliable foundation for optimal performance.
- Elevates surface protection with advanced technology.

VERSATILE WALL PRIMER



MRP - ₹6800

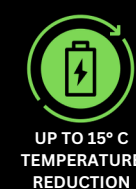

Description

Plast mixer is an acrylic based liquid waterproofing admixture that used to fills the capillary gaps and pores by reaction with cement and sand into the concrete and mortar mixtures.

Instructions for application

- ✓ For Screed application we need to add 250 ml of plast mixture in 50 kg cement mixture.
- ✓ For concrete application ratio of plast mixture and cement – 0.300 ml: 25 kgs.
- ✓ Mix plast mixture and cement thoroughly for desired strength.
- ✓ Maintain precise plast-cement ratios to ensure quality.
- ✓ Adjust ratios for project-specific needs.

Benefits

- Improves adherence and impermeability in plaster and screed.
- Excellent in interior and exterior applications
- High elasticity
- High abrasion resistance
- Improves water and chemical resistance
- Improves durability without any cracks

PLAST MIXER



Description

Sarwin primer 11 is epoxy based solvent free two component primer cured with amine hardener, with good penetrating properties for concrete surface. It may also be used for producing levelling and scratch coats for surface preparation prior to final flooring.

Instructions for application

- ✓ Clean the surface free from dirt, grease, oil residues and existing paint by scrubbing with wire brush / chipping / acid etching / grinding / sand blasting / water jetting and vacuumed clean before application.
- ✓ New concrete surface should be cured for minimum 28 days prior to the applications.
- ✓ Prior to the application of sarwin primer 11, the cracks and joints to be filled with sarwin grout ep.
- ✓ Sarwin primer 11 should be mixed base and hardener mentioned proportion using heavy duty slow speed mixture for 3 minutes to getting homogeneous mixture.
- ✓ Once mixed material to spread the surface to increase the pot life. Apply using trowel, roller or brush .
- ✓ Sarwin primer 11 should be allowed to dry prior to the installation of the next floor coating material, typically 24 hours

Coverage :

5 m² /kg/coat, Apporx.

Benefits

- Solvent free and low viscosity.
- Low viscosity primer its help to penetrates the concrete surface to high bonding strength.
- Excellent intercoat adhesion.
- As primer we used for epoxy and pu based flooring applications.
- Excellent resistance to alkali and various chemicals.
- Easy application by trowel, roller or brush.
- Supplied in small kit pack for ease of mixing and correct proportion to achieve the consistency coating.

SARWIN PRIMER 11



Solvent
Free

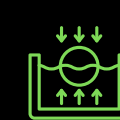

Low
Viscosity



Abrasion
Resistance



Hygienic
Seamless



Various
Colours



Bacteria
Free



ECO
FRIENDLY



ECONOMY

MRP- ₹5900

Description

Sarwin screed 22 is a three-component system based on epoxy resin cured with amine hardener and quartz sand for hard wearing applied between (1 - 4 mm). It combines outstanding mechanical strength with chemical resistance to flooring system. It's used as an intermediate coat before final epoxy self-leveling topping.

Instructions for application

- ✓ Clean the surface free from dirt, grease, oil residues and existing paint by scrubbing with wire brush / chipping / acid etching / grinding / sand blasting / water jetting and vacuumed clean before application
- ✓ New concrete surface should be cured for minimum 28 days prior to the applications.
- ✓ Prior to the application cracks and joints to be filled with SARWIN GUARD EG.
- ✓ Before screed application we need to apply the sarwin primer 11.
- ✓ Sarwin screed 22 should be mixed base, filler and hardener mentioned proportion using heavy duty slow speed mixture for 3 minutes to getting homogeneous mixture
- ✓ Once mixed material spread the surface to increase the pot life. Apply using by trowel method to achieve desire thickness. The surface should be gently rolled with spiked roller to release the air gap also to blend out any trowel marks.
- ✓ Sarwin screed 22 should be allowed to dry prior to the installation of the next floor coating material, typically 24 hours

MRP- ₹7450

Coverage :

5m@2mmthickness/kit

Benefits

- Solvent free and economical.
- Tough and hard wearing with low maintenance.
- Excellent intercoat adhesion.
- As screed we used for epoxy and pu based flooring applications.
- Excellent resistance to alkali and various chemicals.
- Easy application by trowel, roller or brush.
- Supplied in kit pack for ease of mixing and correct proportion to achieve the consistency coating.

SARWIN SCREED 22



Solvent Free



Excellent Durability



Abrasion Resistance



High Strength



Temperature Resistance



Chemical Resistance



Eco-Friendly



Cost-Effective

Description

Sarwin topping 33 is a four component with high gloss, chemical resistance, self-level, hard wearing epoxy resin floor finish applied between 0.5 – 2.0 mm thickness. Ideally suited in situations where a seamless, joint free finish is required and maximum cleanliness is at most.

Instructions for application

- ✓ Clean the surface free from dirt, grease, oil residues and existing paint by scrubbing with wire brush / chipping / acid etching / grinding / sand blasting / water jetting and vacuumed clean before application.
- ✓ New concrete surface should be cured for minimum 28 days prior to the applications.
- ✓ Prior to the application of sarwin primer 11, the cracks and joints to be filled with SARWIN GUARD EP.
- ✓ Before topping application, we need to apply the sarwin primer 11.
- ✓ To required above 2 mm thickness use sarwin screed 22(intermediate coat) for to build the thickness with economical range.
- ✓ Sarwin topping 33 should be mixed base, filler and hardener mentioned proportion using heavy duty slow speed mixture for 3 minutes to getting homogeneous mixture

Once mixed material spread the surface to increase the pot life. Apply using by trowel method to achieve desire thickness. The surface should be gently rolled with spiked roller to release the air gap also to blend out any trowel marks

MRP ₹10250
(incl. of all taxes)

Coverage :

11m @1mmthickness/kit

Benefits

- Solvent free and easy to apply.
- Excellent durable, provides a hard, impact and abrasion resistance to floor topping.
- Hygienic seamless floor which is easy to clean.
- Excellent resistance to alkali and various chemicals.
- Does not support to growth of bacteria and fungus.
- Available in all RAL colours and customization also available.
- Supplied in kit pack for ease of mixing and correct proportion to achieve the consistency coating.

SARWIN TOPPING 33

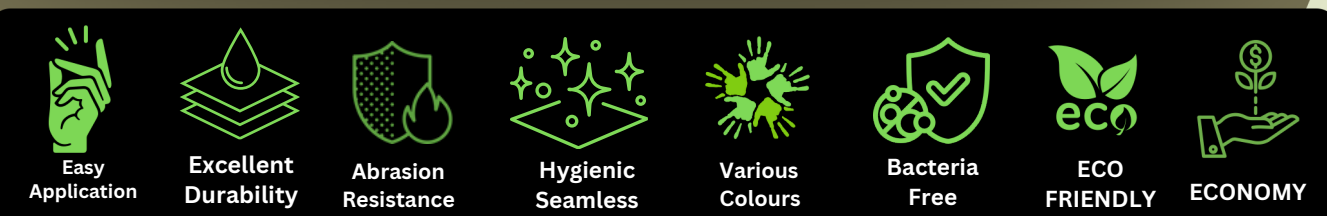

Description

SARWIN GUARD EG is solvent free, hygienic, hard wearing, stainless, chemical resistant, two component coloured epoxy tile grout and tile adhesive for filling joints between ceramic tiles, vitrified tiles, glass mosaic tiles, porcelain tiles, marble and stone. Available in various colours. It is ideal for applications in areas demanding perfect cleanliness, high chemical and mechanical resistance.

Instructions for application

- ✓ Surfaces must be clean, dry, free of any loose or friable particles, contaminants such as dust, dirt, oil, wax polish, grease, cement laitance or efflorescence.
- ✓ Smooth surfaces must be roughened lightly to improve adhesion.
- ✓ To confirm adequate surface preparation and adhesion, carry out a small trial before full application. Prior to the application.
- ✓ SARWIN GUARD EG should be mixed base and hardener mentioned proportion for 3 minutes to getting homogeneous mixture.
- ✓ The mixed grout pot life up to 90 minutes at room temperature.
- ✓ Don't add water or thinner during the mixing.

MRP- ₹4350

Packing size :

1,4 kgs.

Benefits

- Very good workability and easy applications.
- Waterproof and impermeable to liquids.
- High mechanical resistance with good abrasion resistance.
- Excellent resistance to alkali and various chemicals.
- For grout joints between 2 mm – 20 mm .
- Rapid hardening without cracking or shrinkage.
- Easy to clean and maintain.
- Does not support to growth of bacteria and fungus.

SARWIN GUARD EG



Easy
Application



Moisture
Resistance



Abrasion
Resistance



Grout joints
2mm - 20mm



Rapid
Hardening



Bacteria
Free



ECO
FRIENDLY



ECONOMY

THE LIFE EVERYONE DESERVE

TRANSFORM YOUR DREAM HOME INTO REALITY



EXPERT BUILD CARE

Thank you

Office : 0422 4124520

Customer Care : 8110044744

12 x 7 Helpline : 8110044844

 +91 8939845662

www.expertbuildcare.in

 vivek@jcegroups.in

387-B, New, 207, Bharathiyar Road,
near Gandhipuram Town,
Coimbatore, Tamil Nadu - 641044.